

CITYPOINT

The Starting Point

01_ swimming pool

37_ floors

83_ on site staff

120_ metres tall

360_ degree views

36,000_ sq ft of public space



Let's get to the point

more than just a place for work

01_ 34_
business lounge showers
567_ 404_
lockers bike racks



Your new meeting point

- 1 Spaces Business Lounge
- 2 Nuffield Health, Fitness & Wellbeing Gym
- 3 Pret A Manger
- 4 Gatti's
- 5 Spagbowl
- 6 The Refinery
- 7 Bad Egg Bar & Diner
- 8 Wagamama
- 9 Notes
- 10 Chop'd
- 11 Costa Coffee
- 12 Edward Holland
- 13 Notes
- 14 Food Trucks



From point a to b

...is quick by whatever means of transport you choose

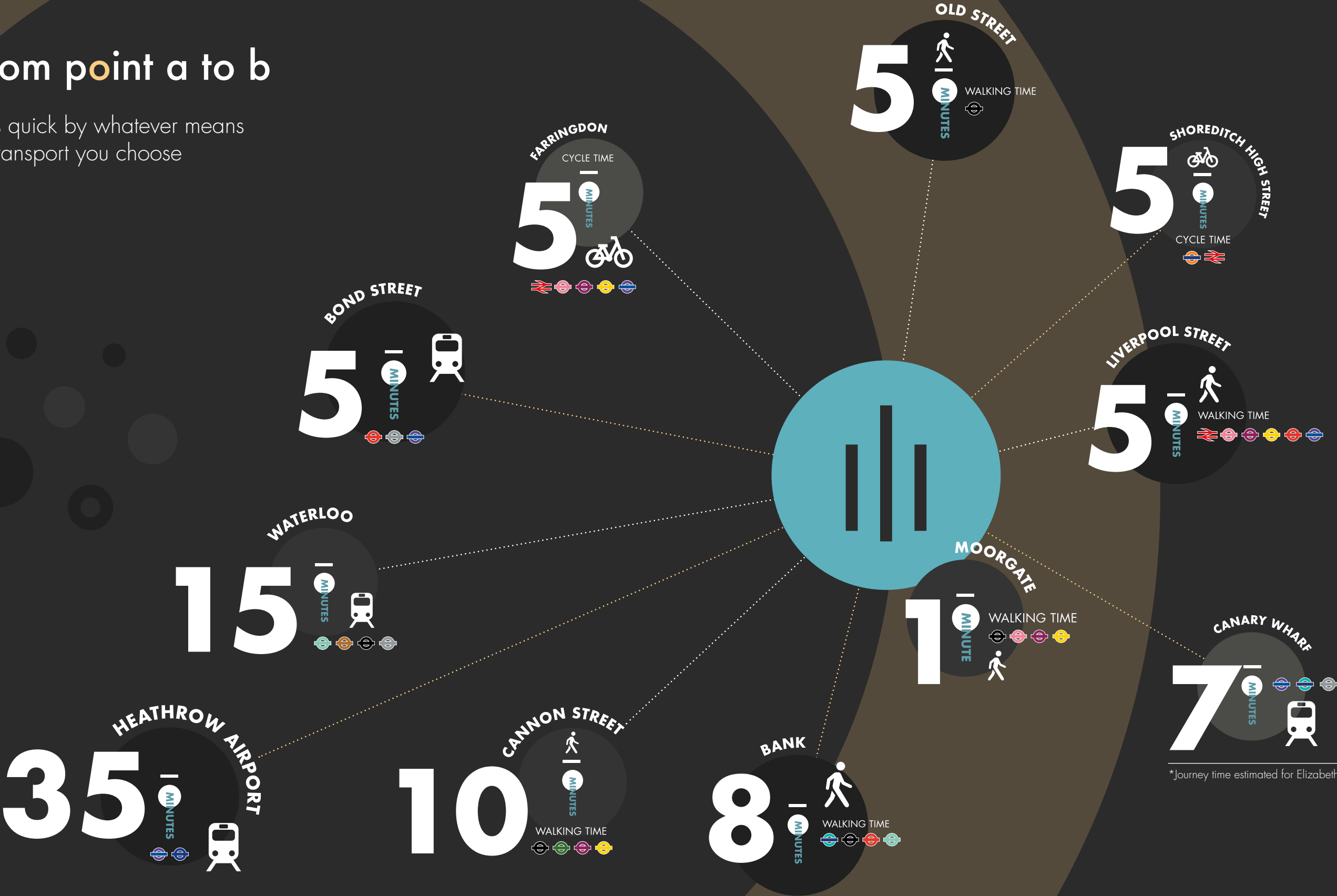

*Journey time estimated for Elizabeth line



It's all about your point of view

Point break

Part Level 15: 4,264 SQ FT

Exposed Ceilings

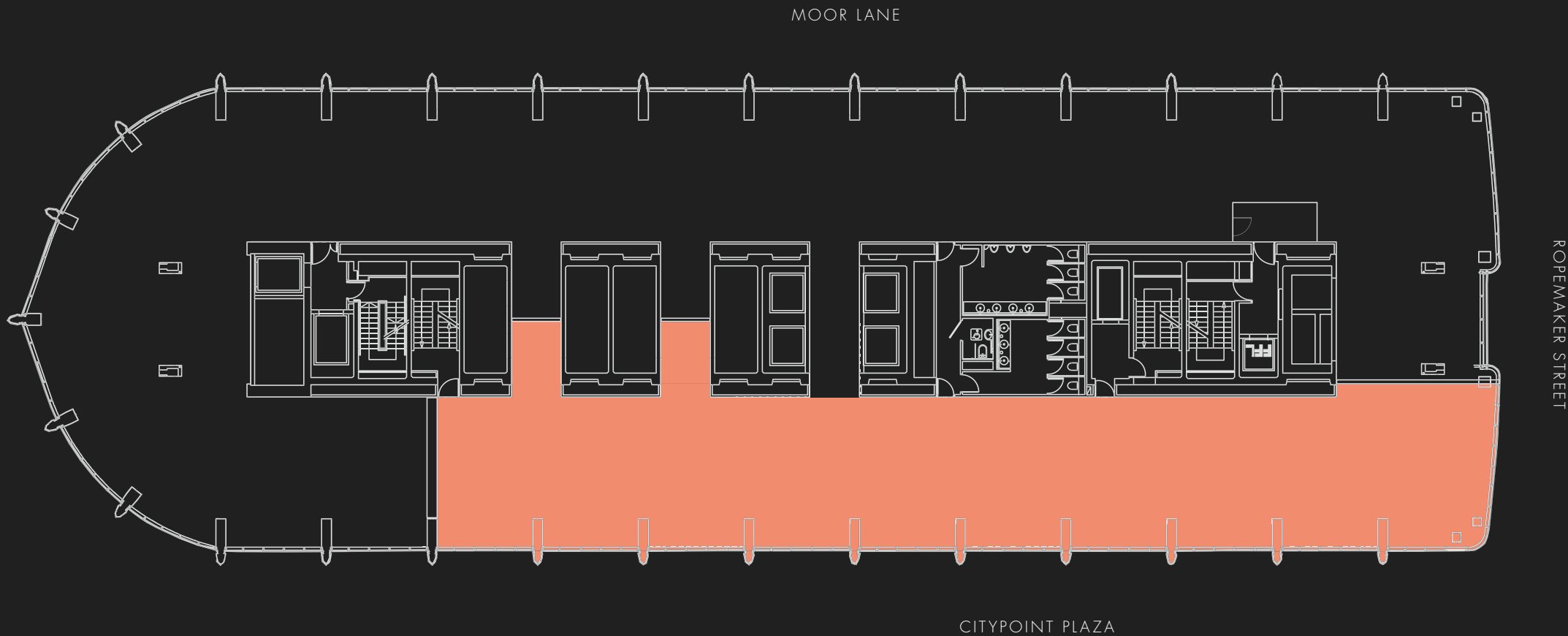

MOORGATE STATION
AND CROSSRAIL

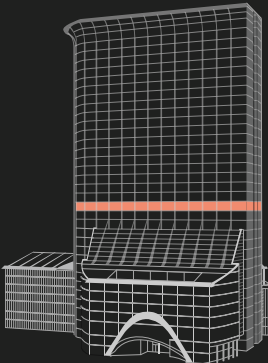

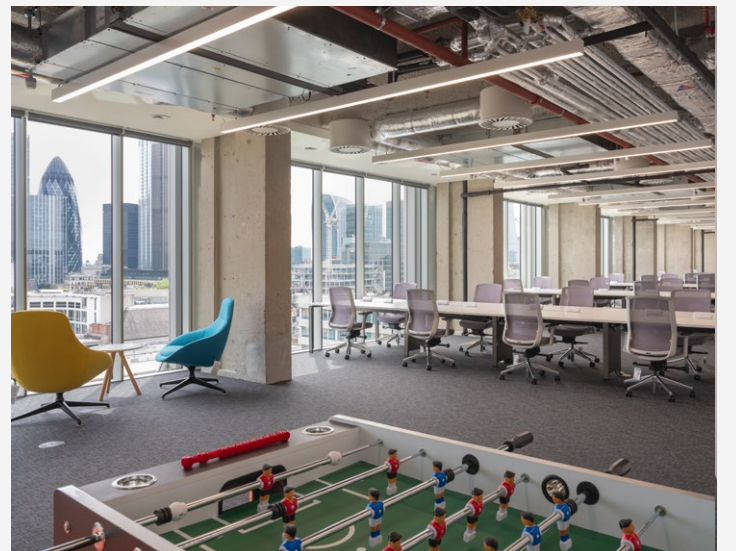



Health, Fitness & Wellbeing Gym

Level 15
Talking Points

1:10

OCCUPATIONAL DENSITY

404

BICYCLE SPACES

4

PIPE FAN COIL A/C

567

LOCKERS

6

PASSENGER LIFTS

1.3_{MVA}

IN EACH OF THE FOUR
STANDBY GENERATORS

100

MM RAISED FLOOR ZONE

89

CAR PARKING SPACES

Points of contact

Brookfield
Properties

REX CONYERS-SILVERTHORN

T: +44 (0) 20 74 08 8274

M: + 44 (0) 7793 808 301

E: rex.conyers-silverthorn@brookfieldproperties.com

CITYPOINT

Misrepresentation Act 1967 & Property Misdescriptions Act 1991: BH2 and CBRE and the lessors notify that these particulars are set out as outlines only and do not constitute any part of an offer/contract. All descriptions, dimensions, necessary permission for use and occupation, and other details are given in good faith and are believed to be correct. Any intending occupiers should not rely on them as statements or representations of fact and must satisfy themselves as to the correctness of each of them. No person employed by the agents has authority to make or give representation/warranty in relation to this property. February 2020